

SCOPE OF WORK AND SPECIFICATIONS  
MOBILE OFFICE TRAILER

Diamond Head State Monument  
Division of State Parks  
Department of Land and Natural Resources

September 2022

SPECIFICATIONS

1. Size and Floor Plan
  - a. Overall size to measure 10' x 32' (315 sq. feet)
  - b. 2 rooms: 10' x 10' and 10' x 20' (see below – not to scale)
  - c. Interior wall ceiling to floor with door

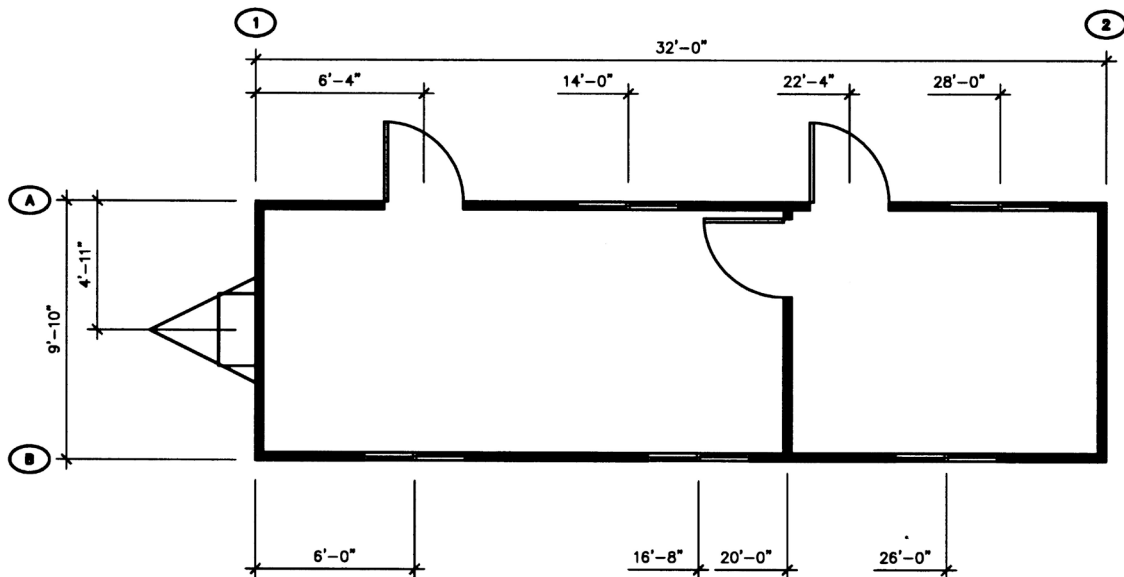

**FLOOR PLAN**  
1/8" = 1'-0" 10 x 32

2. Design Loads
  - a. Floor Min. 50 psf
  - b. Roof Min. 20 psf
  - c. Wind Min. 105/D
3. Frame
  - a. Constructed from steel materials to commercial standards for roadworthiness.
  - b. Standard hitch.
  - c. Axles (2-brake 0-Idler), commercial steel wheels, tires (8:00 x 14.5, 14 ply tires), braking system and all other safety equipment necessary shall be of sufficient capacity to comply

- with the safety requirements for the transport of the mobile office trailer shall be provided.
- d. Frame size: 10' x 32'.
  - e. Main rail: 8" I-beam.
4. Floor
    - a. Joists shall be 2 x 6 @ 16" on center.
    - b. Rim shall be single LVL 5-1/2".
    - c. Bottom boards shall be Class "A" rated and woven polyethylene fabric.
    - d. First decking shall be plywood tongue and groove; 3/4" APA Rated.
    - e. Second decking shall be 1/4" ultraply XL.
  5. Walls
    - a. Exterior framing shall be 2" x 4" @ 16" on center, 96-1/4" height.
    - b. Interior framing shall be 2" x 4" @ 16" on center.
    - c. Insulation at exterior walls shall be R-11
    - d. Siding shall be 7/16" LP Smartside Panel with grooves 8" on center or equivalent treated engineered wood siding which is moisture and termite resistant.
    - e. Trims and corners shall be 1x4 finger jointed cedar.
    - f. Fascia shall be 5/8" Duratemp or equivalent plywood siding.
    - g. Window shall be fastened with stainless steel screws.
    - h. Belt rail shall be 3" x 7/16" LP Smartpanel or equivalent.
  6. Roof
    - a. Framing rafters shall be bow truss @ 24" on center.
    - b. Insulation shall be R30 cellulose blow in.
    - c. Sheathing shall be 7/16" OSB.
    - d. Roof covering shall be 30 ga. galvanized with J-rail and fastened with stainless steel screws.
    - e. Venting at eave. Size is 16' x 8' (4).
  7. Doors
    - a. Two (2) exterior, 3' x 6'8", painted steel door with painted aluminum jamb and stainless steel hinges.
    - b. Tamper resistant locks and dead bolt shall be installed on 2 exterior doors.
    - c. One (1) interior, 3' x 6'8", prehung hollowcore wood door with wood jamb and standard hinges.
  8. Windows
    - a. Minimum of five (5) 4' x 3' windows, horizontal slide.
    - b. Two (2) windows in smaller room and 3 in larger room.
    - c. White vinyl finish with dual low E3 glazing. NO window guards.
  9. Interior Finishes
    - a. Flooring covering shall be vinyl composition tile, 12" x 12" x 1/8", standard stocking commercial color and pattern, sealed, and waxed.
    - b. Wall base shall be manufacturer's standard shoe type molding.
    - c. Interior walls shall be 1/4" paneling (minimum), standard stocking commercial color and pattern.

- d. Ceiling shall be 2' x 4' T-bar type with ceiling panels, manufacturer's standard stocking commercial color and pattern.
- e. Ceiling height shall be approximately 7'6".

#### 10. Ventilation and Air Conditioning

- a. Central air conditioner's capacity shall be appropriate for the location of the office unit.
- b. Wall hung unit with thermostat.
- c. Ceiling shall be ducted for air conditioning.
- d. Temperature control shall be air conditioning manufacturer's standard or recommended thermostat.
- e. All wyes and elbows shall be insulated.

#### 11. Electrical

- a. Single phase.
- b. One (1) 100 amp (minimum) panel
- c. Eight (8) duplex 20 amp receptacles
- d. Conduit material.
- e. Lights: 2' x 4' Troffer, 2 tube with T-8, three (3) each.
- f. Switches as required for each room and open space.
- g. Energy efficient fluorescent lighting, 2 x 4 fixtures, 32 watt tubes.
- h. Trailer shall be fully wired for electricity hook-up.

#### 12. Additional Requirements

- a. ADA ramp for access from the ground to the entrance doors.

### DELIVERY & INSTALLATION

#### 1. Trucking and Delivery

- Delivery location: Interior of Diamond Head Crater  
4250 Diamond Head Road, Honolulu, HI 96816
- Access through tunnel required – height of tunnel is 13' and width approximately 20'.

#### 2. Installation on existing asphalt roadway surface

- a. Blocked and levelled.
- b. Anchored with tiedowns for asphalt.